

**THIS DETAIL APPLIES TO METAL CORRUGATE ROOF PROFILES WITH ROOFPITCHES BETWEEN 15 AND 60 DEGREES.**

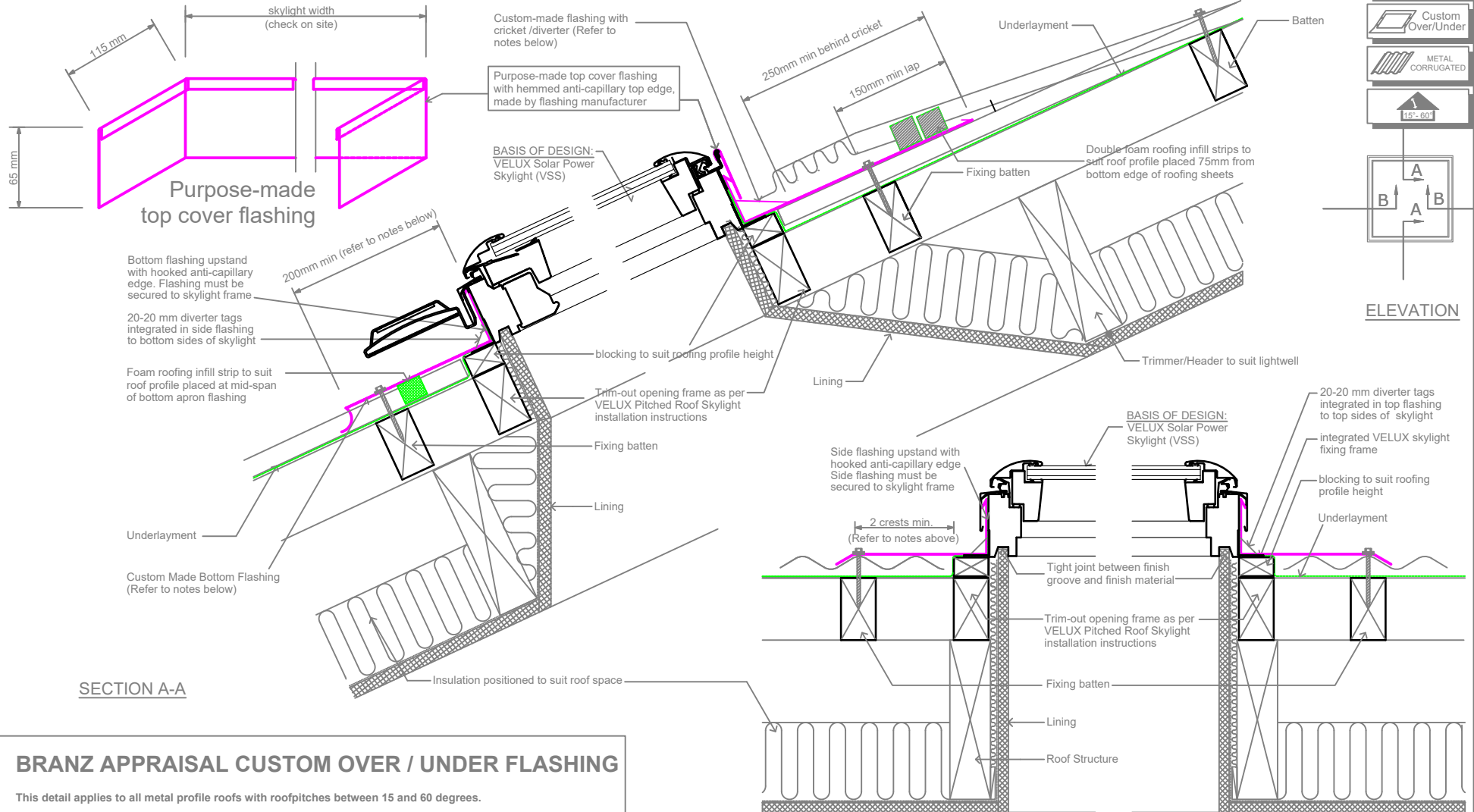

## BRANZ APPRAISAL CUSTOM OVER / UNDER FLASHING

This detail applies to all metal profile roofs with roof pitches between 15 and 60 degrees.

No cricket or diverter required when skylight is less than 600mm wide, and catchment less than 40 sqm.

Custom flashings must be designed to meet the requirements set out in the latest version of the New Zealand Metal Roof and Wall Cladding Code of Practice, and shall be manufactured and installed by a specialist flashing contractor to the latest trade practices.

For roofs with roof pitches less than 15 degrees, the VELUX Skylight must be installed to a min.15 degrees.

The flashing and installation must be guaranteed against weathertightness by the specialist flashing contractor.

Insulation material meeting the requirements of NZBC/H1 is required in the cavities of the lightwell structure.

Name	Date
Drawn by	Mar 19
Checked by	Mar 19
Drawing No.	